

SeaBreezer Fitting Instructions (non cyclonic areas) for a METAL Roof

Tools Required: Safety glasses, neutral cure silicone sealant, jigsaw, spirit level, screwdriver, hammer, adjustable spanner, good grip footwear and a battery drill with a 5/16 hex head socket drive. Please read safety first brochure prior to installation and be aware of risks to working at height.

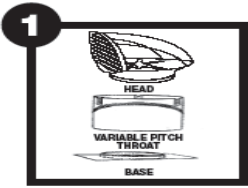

Components

Remove the ventilator from the carton and separate the three main sections: Head, Variable Pitch Throat and Base. Also separate screws, metal strap and clamp. Extra strapping (not supplied) is required for cyclonic fixing. Please refer to pdf on website if cyclonic area fixing is required.

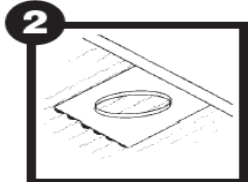

Positioning

For standard SeaBreezer fitting, position on the roof close to the ridge line and place base flashing with top edge slipped under the ridge capping. For SkyVent fixing, position the head unit directly above the position that the diffuser will penetrate the ceiling to keep reflective shaft as straight as possible between the head unit and diffuser.

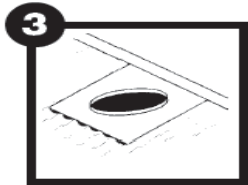

Cutting the Hole

Mark the proposed hole using the base as a template. Cut roof sheet as well as sarking/insulation to allow air flow.

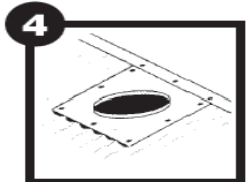

Securing the Flashing

Turn up the corrugation of the metal sheeting within the cut hole, secure the flashing to the sheeting with self tapping screws or rivets. Use silicone to seal after shaping to roof profile as required.

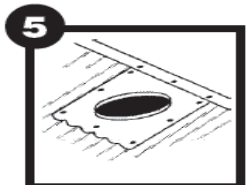

Dressing the Flashing base

Use a rubber mallet/hammer to shape the flashing to the sheeting profile. Carefully cut profile to ribs and silicone seal base to roof

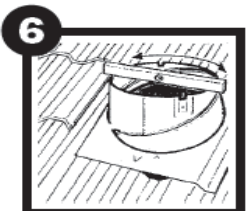

Adjusting Variable Pitch Throat

Fit the variable pitch throat to fit the base and adjust it to suit the roof pitch. Use a spirit level to ensure that the top is level. Check level North – South and East - West. Fasten variable pitch throat to the base flashing using three of the screws provided.

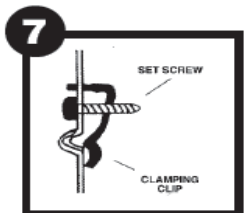

Fixing Variable Pitch Throat

Fix the clamping clip to the inside of the variable pitch seam. Using the set screw provided then screw from the outside to lock seam in place.



Sealing the Variable Pitch Throat

Silicone seal all seams and joints from inside the variable pitch throat. Ensure that all possible points of moisture entry are sealed.

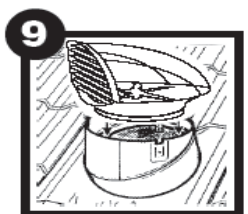

Fitting Turbine

Position *Seabreezer* head on the variable pitch throat and line up pre-drilled holes in brackets with those in variable pitch throat. Fasten with screws provided. **Warning - Do not silicone seal any part of the SeaBreezer head unit as this will void the warranty and may damage polymer components.**

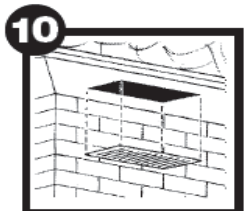

Fitting Under Eave Vents

To assist ventilation flow, two Under Eave Vents may be fitted (not supplied). Cut out an appropriate section of the eave and fix the vent across aperture.