

SeaBreezer Fitting Instructions (Non Cyclonic areas) for a Tiled Roof

Tools Required: Safety glasses, neutral cure silicone sealant, jigsaw, spirit level, screwdriver, hammer, adjustable spanner, good grip footwear and a battery drill with a 5/16 hex head socket drive. Please read safety first brochure prior to installation and be aware of risks to working at height.



Components

Remove the ventilator from the carton and separate the three main sections: Head, Variable Pitch Throat and Base. Also separate screws, metal strap and clamp. Extra strapping (not supplied) is required for cyclonic fixing- refer to cyclonic fixing pdf on website if required.



Positioning

Select a position on the third row of tiles down from the ridge line for standard SeaBreezer fitting. If fitting is for a SkyVent unit, locate directly above the ceiling entry to keep the reflective shaft as straight as possible

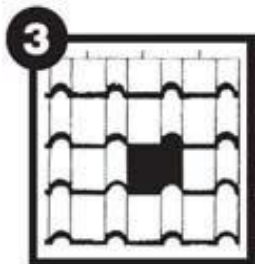

Remove tile and cut away the membrane / sarking lining

If the roof is sarked, then cut the sarking away from the opening to enable a clear airflow.

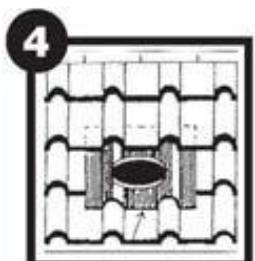

Shaping the Base flashing

Slip the base under the tiles above the hole in the roof. Place your hand through the hole and push the bottom edge of the flashing into the shape of the underside of the tile above, mould and position for water tightness and use silicone to seal as required.



Securing the flashing

Bend the fix fixing strap provided into a U lip to slip over the lower end of the base flashing hole lip and nail or screw fix the other end to timber tile batten. This secures the front of the *SeaBreezer* positively.

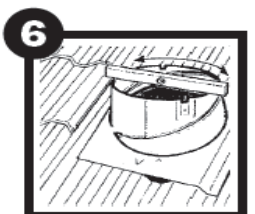

Adjusting Variable Pitch Throat

Fit the variable pitch throat to fit the base and adjust it to suit the roof pitch. Use a spirit level to ensure that the top is level. Check level North – South and East – West (This is extremely important for correct function of the unit to ensure correct tracking into the wind.). Once level, then fasten the variable pitch throat to the base flashing using three of the screws provided.

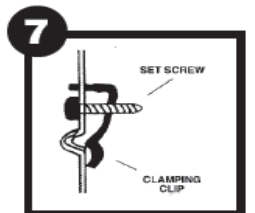

Fixing Variable Pitch Throat

Fix the clamping clip across variable pitch (inside of throat) using set screw (from outside throat) provided lock seam in place.



Sealing the Variable Pitch Throat

Silicone seal all seams and joints from inside the variable pitch throat. Ensure that all possible points of moisture entry are sealed.

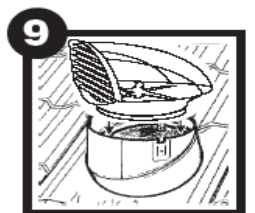

Fitting Turbine

Position *SeaBreezer* head on the variable pitch throat and line up pre-drilled holes in brackets with those in variable pitch throat. Fasten with screws provided. **WARNING Do not silicone seal any part of the *SeaBreezer* head unit as this will void the warranty and may damage polymer components.**

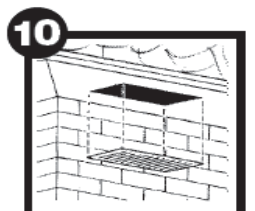

Fitting Under Eave Vents

To assist ventilation flow, two Under Eave Vents may be fitted (Not supplied). Cut out an appropriate section of the eave and fix the vent across aperture.